

# PLAT OF SURVEY

LOTS 39 THROUGH 43 OF BLOCK 5 OF LAKE IVANHOE RESORT  
LOCATED IN PART OF THE NE 1/4 OF THE NW 1/4 OF  
SECTION 2, TOWN 1 NORTH, RANGE 18 EAST,  
WALWORTH COUNTY, WISCONSIN

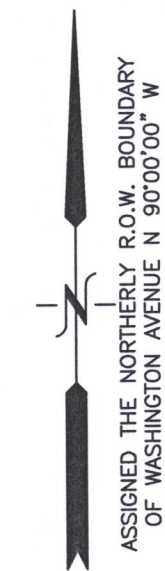

PLAT OF SURVEY  
TOWN OF BLOOMFIELD  
WALWORTH COUNTY, WISCONSIN



## LEGEND

- = FOUND IRON PIPE STAKE
- = FOUND IRON REBAR STAKE
- ✱ = SET IRON REBAR STAKE
- {xxx} = RECORDED AS

(A)

PART OF TAX PARCEL MIR 00082 (LOTS 39 THROUGH 41)  
TO BECOME APPURTENANT TO TAX PARCEL MIR 00079.  
6,342 SQ. FT. (0.15 ACRES), MORE OR LESS.

(B)

PART OF TAX PARCEL MIR 00082 (LOTS 42 AND 43) TO  
BECOME APPURTENANT TO TAX PARCEL MIR 00083.  
4,000 SQ. FT. (0.09 ACRES), MORE OR LESS.

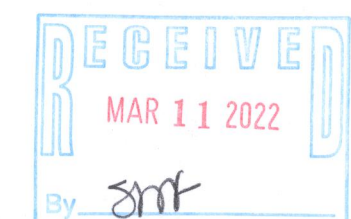

NOTE: COPIES OF THIS MAP TO WHICH THE FOLLOWING CERTIFICATE WILL APPLY SHOW  
THE SURVEYOR'S ORIGINAL SEAL AND SIGNATURE IN RED INK. COPIES BY ANY OTHER  
MEANS MAY HAVE ALTERATIONS WHICH DO NOT REPRESENT THE SURVEYOR'S WORK  
PRODUCT.

I HEREBY CERTIFY THAT THE ABOVE DESCRIBED PROPERTY HAS BEEN SURVEYED  
UNDER MY DIRECTION AND THAT THE ABOVE MAP IS A TRUE REPRESENTATION  
THEREOF AND SHOWS THE SIZE AND LOCATION OF THE PROPERTY AND ITS EXTERIOR  
BOUNDARIES. THIS SURVEY IS MADE FOR THE USE OF THE PRESENT OWNERS OF THE  
PROPERTY, AND ALSO THOSE WHO PURCHASE, MORTGAGE, OR GUARANTEE THE TITLE  
THERE TO WITHIN ONE YEAR FROM THE DATE HEREOF.

DATED: 1/19/2022

*Christopher A. Hodges*  
CHRISTOPHER A. HODGES P.L.S. 2760

WORK ORDERED BY -  
TONY MARINELLO  
N2457 TUSKEGEE DRIVE  
BURLINGTON, WI 53105

FARRIS, HANSEN & ASSOCIATES, INC.  
ENGINEERING - ARCHITECTURE - SURVEYING  
7 RIDGWAY COURT P.O. BOX 437  
ELKHORN, WISCONSIN 53121  
OFFICE: (262) 723-2098 FAX: (262) 723-5886

## REVISIONS

PROJECT NO.  
10619  
DATE:  
01/19/2022  
SHEET NO.  
1 OF 1

RICHARD COURT {40' WIDE R.O.W.}

TUSKEGEE DRIVE {30' WIDE R.O.W.}

WASHINGTON AVENUE {40' WIDE R.O.W.}

DUMAS DRIVE  
{30' WIDE R.O.W.}

BLOCK 6



PLAT OF SURVEY PREPARED BY MARK L. MIRITZ DATED  
4/11/2007 SHOWS MONUMENTATION ON THE SOUTHERLY  
RIGHT OF WAY BOUNDARY OF WASHINGTON AVENUE  
THAT CONFIRMS 40' R.O.W. WIDTH FROM THIS LINE.

X:\PROJECTS\10619\ACAD\10619.dwg

MIR-82

118-3577